



**Monks Park Road**

**oriordanbond**  
SALES & LETTINGS



GROUND FLOOR  
473 sq.ft. (44.0 sq.m.) approx.



1ST FLOOR  
370 sq.ft. (34.4 sq.m.) approx.



# Monks Park Road

NN1 4LX

GUIDE PRICE £160,000

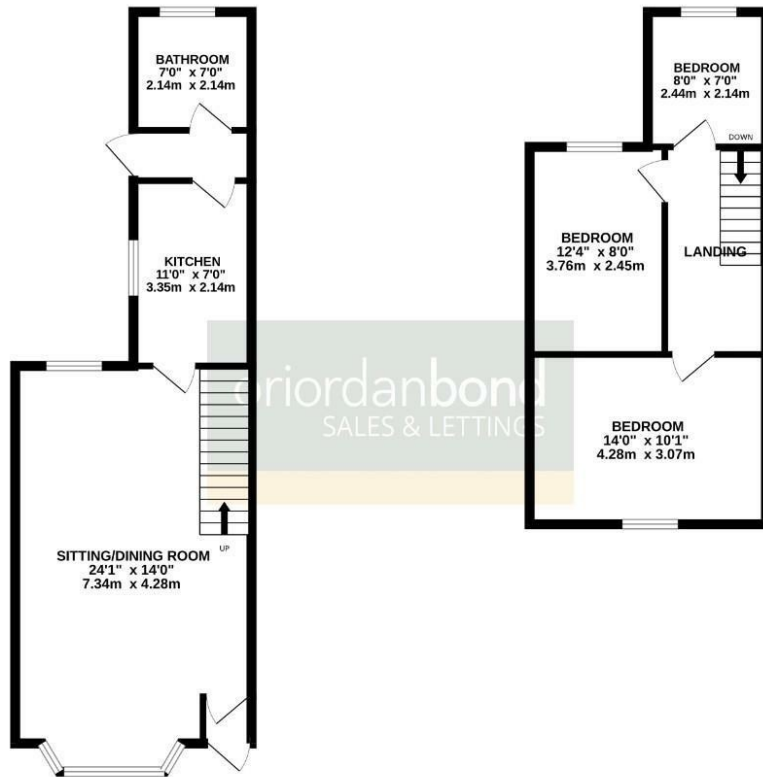

O'Riordan Bond  
SALES & LETTINGS

TOTAL FLOOR AREA: 843 sq.ft. (78.4 sq.m.) approx.  
Whilst every effort has been made to ensure the accuracy of the floorplan contained here, measurements of doors, windows, rooms and any other items are approximate and no responsibility is taken for any error, omission or mis-statement. This plan is for illustrative purposes only and should be used as such by any prospective purchaser. The services, systems and appliances shown have not been tested and no guarantee as to their operability or efficiency can be given.  
Made with floorplan-creator.com

### Additional information

- Council Tax Band:
- Energy Efficiency Rating:

### Viewing

Viewing strictly by appointment – details below

### Disclaimer

O'Riordan Bond Estate Agents Limited has not tested apparatus, equipment, fittings or services and so cannot verify they are in working order. The buyer is advised to obtain verification from their solicitor or surveyor.

O'Riordan Bond Abington Sales  
01604 639007

abington@oriordanbond.co.uk

